

M101BK

8" Intel® Celeron® N2930 Windows Vehicle Mounted Computer

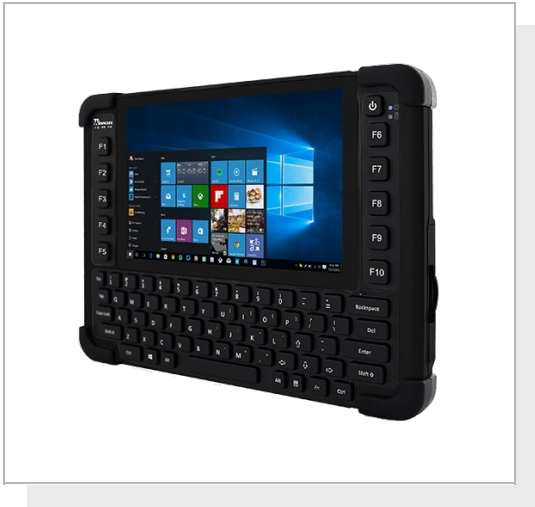

KEY FEATURES

- Long battery life with Intel® Celeron® N2930 Bay Trail-M Processor , 8inch Windows Vehicle Mounted Computer
- 8" 1280x800 wide viewing angle with PCAP touch
- 5MP Auto-focus camera
- IP65 waterproof and dustproof
- ISO/IEC 9995-3 QWERTY Keypad
- Hot-swappable battery design with optional high capacity battery pack
- MIL-STD-810G compliant
- Optional extendable UHF RFID Reader
- Optional built-in 1D/2D Barcode, HF RFID Reader



SPECIFICATIONS

Display	
Resolution	1280x800
Contrast Ratio	800:1
View Angles	88,88,88,88
Size	8 inches
Panel Brightness	500 nits
Touch / Glass	Projected Capacitive Multi Touch Screen
System Specification	
Processor	Intel® Celeron® N2930 (2M Cache, up to 2.16 GHz)
Storage	1 x mSATA SSD 64GB mSATA SSD up to 512GB (Optional)
Security	TPM 2.0
Memory	1 x SO-DIMM, DDR3L 1600 MHz, 4GB 8GB (Optional)
WLAN	Wi-Fi Support
WWAN	4G LTE (Optional)
Ethernet controller	1 x Intel® Ethernet Controller WG82574L
Operating System	Windows 7 Embedded Systems (Optional) Windows 10 IoT Enterprise (Optional) Linux Ubuntu 18.04 (Optional)
BT	BT Support
GNSS	GPS, GLONASS
Environment	
Operating Humidity	10% to 90% RH, Non-Condensing, MIL-STD 810G Method 507.5 Procedures I
Operating Temperature	AC Mode: -20°C to 60°C (-4°F to 140°F), Battery Mode: -10°C to 50°C (32°F to 122°F), MIL-STD 810G Method 501.5 Procedures II, Method 502.5 Procedures II
Storage Temperature	-30°C to 70°C (-22°F to 158°F), MIL-STD 810G Method 501.5 Procedures I, Method 502.5 Procedures I
Shock	MIL-STD-810G Method 516.6 Procedure I
Vibration	MIL-STD-810G Method 514.6 Procedure I
IP rating	IP65
Certification	
Certification	CE, FCC
Mechanical	
Dimension	271.8 x 198.2 x 22 mm
Weight	1.35 kg (3 lbs)
Enclosure	Plastic
Cooling System	Fanless Design
Accessory	
Accessory	Adapter and Power Cord
Optional Accessory	Desk Dock (Optional)

Capacitive Stylus
Standard Battery

Vehicle Dock (Optional)
Battery Charger (Optional)
High Capacity Battery (Optional)
Hand Strap (Optional)
UHF RFID Reader (Optional)
VESA Mount Kit (Optional)
Smart Card Reader (Optional)
Shoulder Strap (Optional)
LAN Cable (Optional)
Micro HDMI Cable (Optional)
RS232 Cable (Optional)
Vehicle Charger (Optional)

IO Ports

USB Port	1 x USB 3.0	SD Card Slot	1 x Micro SD Slot
Video	1 x Micro HDMI (Optional)	Audio	2 x Stereo Speaker 1 x 3.5mm Audio Combo Conn. (Mic in or Line Out)
Expansion Port	1 x Expansion Connector for USB 2.0 / Full RS232 (Optional)	LAN	1 x 30-pin Combo Conn for Giga-LAN or RS232
Indicator	Power, Battery, HDD, RF		

Power

Battery	7.4V, typ. 5140 mAh Li-Polymer Battery (2S1P) ; 7.4V, typ. 10280 mAh Li-Polymer Battery (Optional)	Battery Operating Time	Operating Time Std. Battery: 6 hours ; High Capacity Battery: 12 hours (tested with MobileMark 2007)
Power Rating	19V DC	Adapter	100-240V, 50-60Hz / 19V DC

Camera

Rear Camera	5MP auto-focus camera with LED flash
--------------------	--------------------------------------

Barcode Scanner

Barcode Scanner	1D/2D Barcode Reader (Optional)
------------------------	---------------------------------

Control

Button	Physical Buttons: ISO/IEC 9995-3 QWERTY Keypad , IP65 water and dust proof, with LED backlight (keypad dimensions : min. 10x10mm) 1 x Power, 10 x Function Keys (programmable by Hottab)
---------------	--

DIMENSIONS UNIT:MM

Winmate M101BK

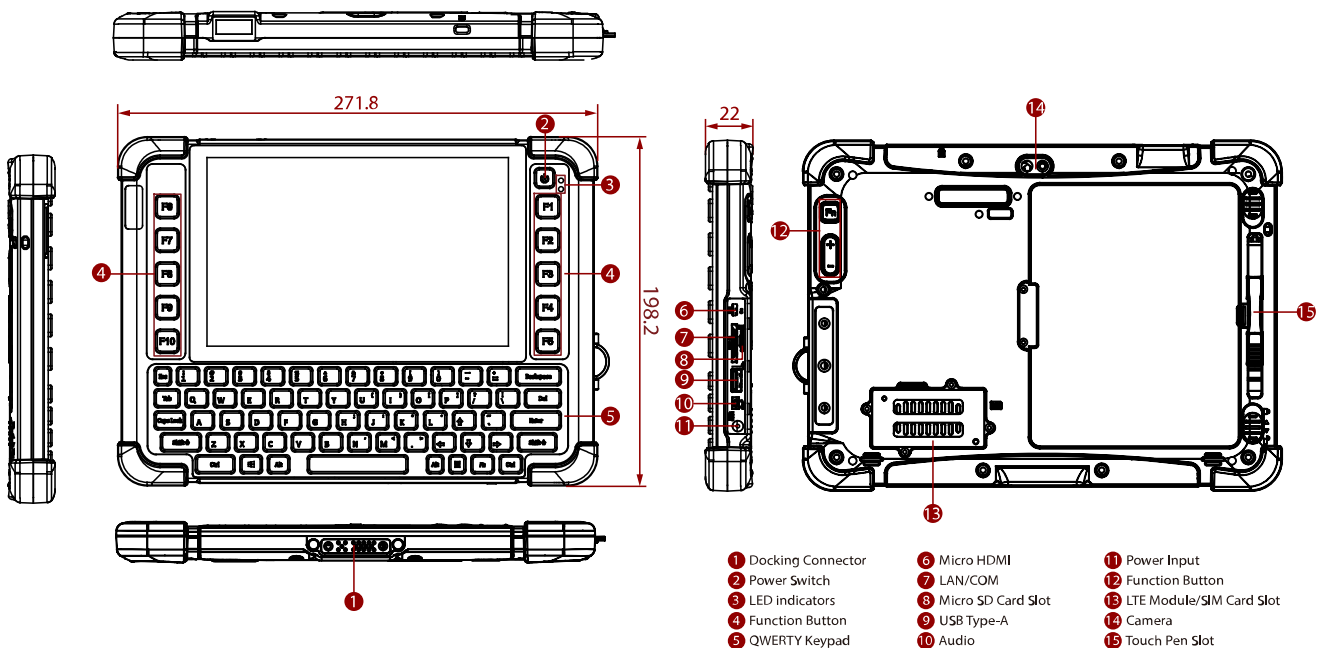

NOTE

1. Total usable memory will be less dependent upon actual system configuration.
2. 1D/2D Barcode Reader and HF RFID Reader are mutually exclusive options.
3. Length measurements do not include protrusions. Weight varies with options.
4. The drop test with a high-capacity battery must come with a hand strap.
5. Measured at dimming LCD brightness. Varies depending on the usage conditions, or when an external device is attached.
6. Accessories may vary depending on your configuration.
7. This is a simplified drawing and some components are not marked in detail.
8. The product shown in this datasheet is a standard model. For diagrams that contain customized or optional I/O, please contact the Winmate Sales Team for more information.